

## SAFETY SIGN SECTIONS

An aluminium framing solution for emergency and safety signs for double or single sided applications.

- Double sided application allows a maximum of 2mm substrate per side. Once frame is in place the corners can be glued to the frame to secure the substrate and hold the frame.
- Aluminium profiles in 3m lengths, available in Mill and Silver (Anodised) finish.

### SAFETY SIGN ALUMINIUM PROFILE

product code (mill finish)

**ALSSAFETYSIGN/M**

product code (silver/anodised finish)

**ALSSAFETYSIGN/S**

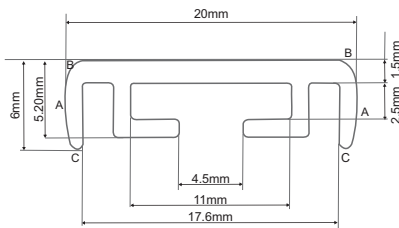

### SAFETY SIGN CORNER - GREY



product code

**ALSSAFETYSIGN/CNR**

### SAFETY SIGN WALL MOUNT SET - GREY

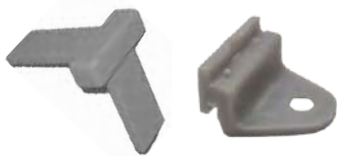

product code

**ALSSAFETYSIGN/WMSET**

(4 - corners & 2 - wall mount clips)

### SAFETY SIGN HANGER SET - GREY



product code

**ALSSAFETYSIGN/HANGSE**

(4 - corners & 2 - suspension clips)



NATIONAL DISTRIBUTION ☎ 086 1100 420

✉ alumina@maizey.co.za 🌐 www.maizey.co.za

🛒 Shop online [www.maizeyonline.co.za](http://www.maizeyonline.co.za)

📱 Get social @ Maizey.Plastics 📺